

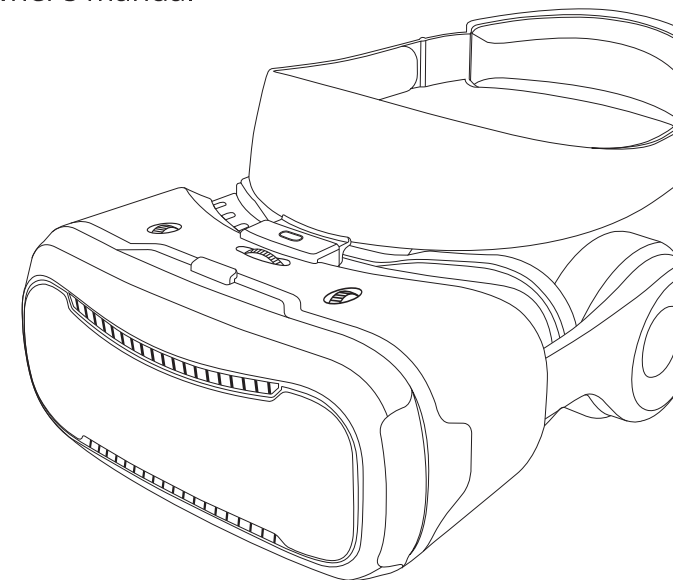

VR 1000HP

VIRTUAL REALITY GLASSES

Owner's manual



- 1. Front cover lock
- 2. Image width adjustment
- 3. Headband
- 4. Image sharpness adjustment
- 5. Front cover



- 6. Headphones
- 7. Head size adjustment
- 8. Flexible headset adjustment

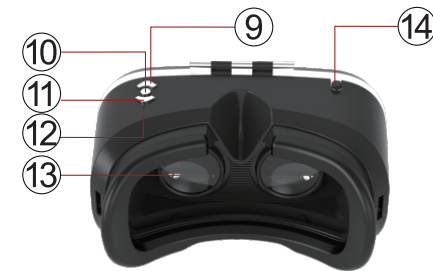

- 9. Volume +
- 10. Multi-function button
- 11. Volume -
- 12. Microphone
- 13. Optical lenses
- 14. Touchscreen button

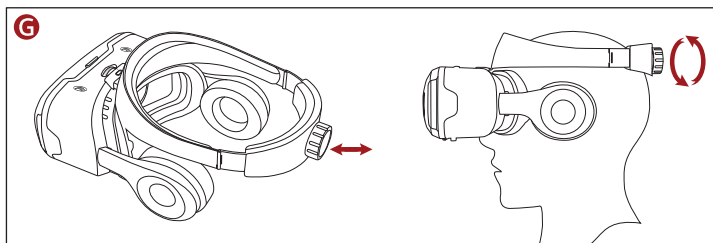
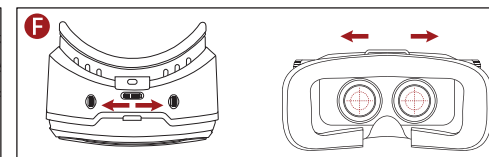
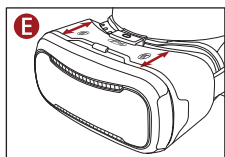
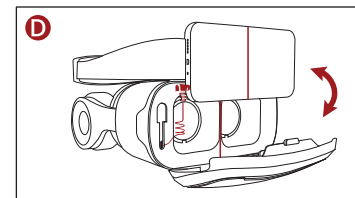
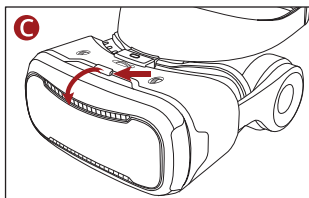
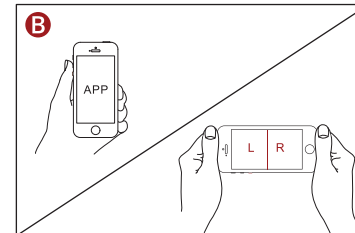
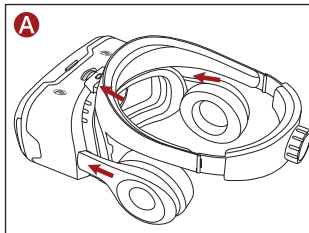

Dear customer,
Thank you for choosing the Mac Audio VR 1000H.
Please read the following information carefully before starting to use this device.

SAFETY INSTRUCTIONS
The intensive virtual reality experience of the Mac Audio VR 1000HP can greatly distract you from the real-world environment. For safety reasons, you should only use the Mac Audio VR 1000HP when seated. During use, please make sure that you are not in the immediate vicinity of other people, dangerous objects and fixtures or fittings such as stairs, windows, balconies or furniture so as not to expose yourself to hazardous situations.
Do not use the Mac Audio VR 1000HP when actively involved in road traffic situations.

In order to avoid damage to hearing, reduce the volume of the source device before connecting the headphones. Only then, after connecting and putting on, should the volume be increased until a comfortable level is reached. Longer-term listening at high volumes can lead to gradual and permanent hearing loss. Therefore do not listen at high volumes over longer periods, and have regular breaks from listening.

When wearing the Mac Audio VR 1000HP, health restrictions, discomfort, uneasiness or other symptoms can occur on account of the strong visual impressions generated by your smartphone. In such a case, we advise you to stop using the device immediately.
We also expressly recommend taking a break after 30 minutes use.

Never use the device while the smartphone is on charge.

To avoid overheating of the inserted smartphone, the front cover (5) can be removed if necessary.

INSTRUCTIONS FOR DISPOSAL
In accordance with European Directive 2012/19/EU all electrical and electronic appliances must be disposed of separately via local collection points. Please observe the local regulations and do not dispose of your old appliances with normal household waste.

FIRST STEPS
Please connect the two headphone units (6) and the headband (3) to the VR glasses (see Fig. A).

1. Activate the desired VR application on your smartphone (see Fig. B).
2. Open the front cover on the VR headset (see Fig. C).
3. Insert your smartphone in the VR 1000HP (see Fig. D). Make sure the smartphone is exactly in the middle.
Smartphones of different sizes can be secured using the adjustment mechanism.
To use the headphone function, connect the smartphone to the 3.5 mm jack plug.
4. Close the front cover.

IMAGE SETTINGS

- You can adjust the image sharpness to your left and right eye using the controls (4) (see Fig. E).
- The image width can be adjusted to the respective smartphone using the control (2) (see Fig. F).

SETTING THE HEADBAND (see Fig. G)

- Pull the knob (7) out gently. You can adjust the headband to the size of your head by turning the knob. Then push the knob (7) back in.

CONTROLS
▶ **|| (Multi-function button) (10)**

Press once: Take call	Press and hold the button: End call	Press once: Start music playback	Press once: Interrupt music playback	Press three times: Play back last music title	Press twice: Play back next music title

Volume buttons ◀ and ▶ (9/11)
To set the volume.

Please note that the setting options can vary according to the smartphone used.

Technical specifications
Compatibility: 3.5" - 5.5" smartphones
Platform: iOS / Android
PD adjustment: 60 - 67 mm
Dimensions: 320 x 145 x 170 mm
Weight: 561 g
Field angle: 96°

Technical modifications reserved.

WARRANTY INFORMATION
We grant a 2-years warranty for this product.
The equipments are checked and tested continuously during the entire production process. In case you have problems with your equipment, kindly observe the following:

1. The guarantee period commences with the purchase of the component and is applicable only to the original owner.
2. During the guarantee period we will rectify any defects due to faulty material or workmanship by replacing or repairing the defective part at our discretion. Further claims, and in particular those for price reduction, cancellation of sale, compensation for damages or consequential damages, are excluded.
3. Unauthorized tampering with the equipment will invalidate this guarantee.
4. Consult your authorized dealer first, if guarantee service is needed. Should it prove necessary to return the component to the factory, please insure that • the component is packed in original factory packing in good condition • your enclose your receipt as proof of purchase.
5. Excluded from the guarantee are: • Illuminates • Wear parts • Shipping damages, either readily apparent or concealed (claims for such damages must be lodged immediately with forwarding agent, the railway express office or post office).
- Scratches in cases, metal components, front panels, etc. (You must notify your dealer directly of such defects within three days of purchase.)
- Defects caused by incorrect installation or connection, by operation errors (see operating instructions), by overloading or by external force. • Equipments which have been repaired incorrectly or modified or where the case has been opened by persons other than us.
- Consoquential damages to other equipments. • Reimbursement of cools, without our prior consent, when repairing damages by third parties • Batteries and battery packs.